

Lavatory Sinks

DROP-IN LAVATORY SINKS

Vitreous China, 19" round,
8" Faucet Center

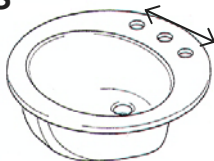

part no.	description	box	carton	price
58015-8	White	1	1	37.50
58014-8	Biscuit	1	1	40.00

UNDER-COUNTER LAVATORY SINKS

Vitreous China,
No faucet hole.
17" X 20", With Clips.



part no.	description	box	carton	price
58016	White	1	1	37.50
58017	Biscuit	1	1	40.00

Kitchen Sinks

STAINLESS STEEL KITCHEN SINK

3 Holes, Overall Size 25" X 22",
Sound Deadening Pad.
Self-Rimming, Satin Finish,
Includes Clips.



part no.	description	min.	carton	price
57551	6" Deep, gauge 22	10	1	63.75

STAINLESS STEEL KITCHEN SINK

3 Holes, Overall Size 25" X 22",
304L Stainless, Sound Deadening Pad.
Self-Rimming, Satin Finish, IncludXVes Clips.



part no.	description	min.	carton	price
57553	7" Deep, gauge 18	10	1	120.00
57555	8" Deep, gauge 18	10	1	150.00

Kitchen Sinks

STAINLESS STEEL KITCHEN SINK

33" X 22", 22 Gauge,
6" Deep.
Satin Finish, Bracket
& Sound Deadening Included.
Clips Included. Made in China.



part no.	description	min.	carton	price
57342-3	3-hole	10	100	75.00
57342-4	4-hole	10	100	75.00

STAINLESS STEEL KITCHEN SINK

Double Bowl with 4 Holes,
Overall Size 33" X 22",
Satin Finish, 304L
Stainless, Gauge 18 Heavy
Duty, Sound Deadening Pad.
Self-Rimming,, Includes Clips.



part no.	description	min.	carton	price
57320	7" Deep, satin	10	1	142.50
57323	8" Deep, satin	10	1	162.50

Bar Sinks

STAINLESS STEEL BAR SINK

2-Hole, Overall Size 15" X 15",
304L Stainless,
Sound Deadening Pad.
Self-rimming, Satin Finish,
Includes Clips.



part no.	description	min.	carton	price
57434	6" Deep, gauge 20	10	1	62.50

No-Hole Kitchen Sinks

S. S. KITCHEN SINK WITH NO FAUCET HOLES

33" X 19",
Two-Compartment,
No-Hole on Deck.
Gauge 20. Satin Finish.



part no.	description	min.	carton	price
57319	6" Deep	10	1	110.00
57318	8" Deep	10	1	180.00

MOUNTING CLIPS FOR COUNTER-TOP SINKS

Stainless Steel Clips with Screws,
for "U" Channel Type.



part no.	description	min.	carton	price
57301	8 Pcs pack	10	50	8.62
P57301	Retail package in clam shell			10.42

FAUCETS

FAUCET REPAIR

SHOWER & TUB

SINKS

TOILET REPAIR

VALVES

PIPE REPAIR & FITTINGS

PLUMBING SPECIALTY

TUBULAR

BATHROOM FIXTURE

PLUMBING TOOLS

DISPLAY STUFF

No-Hole Kitchen Sinks

S. S. KITCHEN SINK WITH NO FAUCET HOLES

25" X 19",
Single-Compartment,
No-Hole on Deck. Gauge 20



part no.	description	min.	carton	price
57519	6" Deep	10	100	97.50
57518	8" Deep	5	50	162.50

Under-Mount Kitchen Sinks

UNDER-MOUNT KITCHEN SINKS

304L Stainless Steel,
Sound Deadening Pad.
31.5" x 20.5" x 9"Depth,
Two Bowls Are Exactly
Same Size (Inside) : 14" X 18".



part no.	description	min.	carton	price
57699		5	1	375.00

Under-Mount Kitchen Sinks

UNDER-MOUNT KITCHEN SINKS

304L Stainless Steel,
Sound Deadening Pad.



Overall Size: 31.5" x 21" x 8"7/8". Large-Bowl's Size:
17.50" X 18.50", Small-bowl's Size: 10 1/4"

part no.	description	min.	carton	price
57697LR	Large on right	5	26	325.00
57697LL	Large on left	5	26	325.00

UNDER-MOUNT KITCHEN SINKS

304L Stainless Steel,
Sound Deadening Pad.
Single Bowl. 23.5" x 21". Depth



part no.	description	min.	carton	price
57615		5	1/stacked	237.50

MOUNTING CLIPS FOR UNDER-MOUNT SINKS

Stainless Steel Clips with Screws,
for "U" Channel Type.



part no.	description	min.	carton	price
57654	8 Pcs pack	10	50	9.50
P57654	Retail package in clam shell			11.25

UNDER-MOUNT KITCHEN SINKS

304L Stainless Steel,
Sound Deadening Pad.
Overall Size: 31.5" x 20.5"
x 8"7/8" depth,



Large-Bowl Size (Inside): 14" X 20 1/4",
Small-Bowl Size (Inside): 14" X 18".

part no.	description	min.	carton	price
57621lr	Large on right	5	26	275.00
57621ll	Large on left	5	26	275.00

UNDER-MOUNT KITCHEN SINKS

304L Stainless Steel,
Sound Deadening Pad.
Overall Size: 31.5" x 20.5"
x 9"7/8" depth,



Large-Bowl Size (Inside): 14" X 20 1/4",
Small-Bowl Size (Inside): 14" X 18".

part no.	description	min.	carton	price
57622lr	Large on right	5	26	350.00
57622ll	Large on left	5	26	350.00

Garbage Disposer s

1/3 HP GARBAGE DISPOSER

Monarch 1/3 HP disposers provide
18 month replacement warranty.
Galvanized grinding components,
corrosion-resistant inside and out.
Cast stainless steel 360 degree anti-jam
swivel impellers. Power cord included.



part no.	description	min.	carton	price
810xl	1/3 HP	1	4	98.75

1/2 HP GARBAGE DISPOSER

Monarch 1/2 HP disposers provide 2 year
replacement warranty. Galvanized grinding
components, corrosion-resistant inside
and out. Cast stainless steel 360 degree
anti-jam swivel impellers.
Power cord included.



part no.	description	min.	carton	price
820xl	1/2 HP	1	4	113.75

Garbage Disposers

1/2 HP GARBAGE DISPOSER

Monarch 1/2 HP disposers provide 3 year replacement warranty. Stainless steel grinding components, corrosion-resistant inside and out. Cast stainless steel 360 degree anti-jam swivel impellers. 1/2 sound shell. Power cord included.



part no.	description	min.	carton	price
880xl	1/2 Hp, w. sound shell	1	4	205.19

3/4 HP GARBAGE DISPOSER

Monarch 3/4 HP disposers provide 5 year replacement warranty. Stainless steel grinding components, corrosion-resistant inside and out. Cast stainless steel 360 degree anti-jam swivel impellers. 3/4 sound shell. Power cord included.



part no.	description	min.	carton	price
890XL	3/4 Hp, w. sound shell	1	4	312.54

GARBAGE DISPOSER FLANGE & COVER
Fit In-Sink Erator.



part no.	description	min.	carton	price
52081	Chrome	3	25	24.63
52082	Satin nickel	3	25	32.00
52083	Red oil bronze	3	25	35.20
52084	Black oil bronze	3	25	35.20
52085	PVD	3	25	38.35

Kitchen-Sink Strainers

DUO BASKET STRAINER - STAINLESS STEEL

Post Type Basket Insert.
4 1/2" Flange.
Fits 3 1/2" to 4" Sink Opening.



part no.	description	min.	carton	price
52002	Stainless steel	10	50/box	7.28

DUO BASKET STRAINER - ABS

Stainless Steel Clad ABS.
Post Type Basket Insert.
4 1/2" Flange.
Fits 3 1/2" to 4" Sink Opening.



part no.	description	min.	carton	price
52001	ABS	10	50	3.65

Kitchen-Sink Strainers

DOUBLE CUP BASKET STRAINER - STAINLESS STEEL

Post type Basket Insert.
4 1/2" Flange.
Fits 3 1/2" to 4" Sink Opening.



part no.	description	min.	carton	price
52004	Stainless steel	5	50	19.20

QUICK-CONNECT BASKET STRAINER

Stainless Steel,
Three Bolt Flange Installation,
4 1/2" Flange,
Fit 3 1/2" to 4" Opening.
Individually Packed with Bar Code.



part no.	description	min.	carton	price
52011	Post type	10	50	9.50

REPLACEMENT BASKET

3 1/2" Diameter with Rubber Seal. Stainless Steel.

52006



52005



part no.	description	min.	carton	price
52005	Flat bottom	10	100	1.90
52006	Post type	10	100	1.73
P52005	Retail package in clam shell			3.40
P52006	Retail package in clam shell			3.23

"SPIN & SEAL" BASKET STRAINER

Stainless Steel.
Threaded Post type Basket Insert.
Fits 3 1/2" to 4" Sink Opening.



part no.	description	min.	carton	price
52000	w. Die cast nut	5	50	14.63
52000B	w. Brass nut	5	50	15.85

REPLACEMENT BASKET FOR SPIN & SEAL

Stainless Steel.



part no.	description	min.	carton	price
51999		1	50	4.50

FAUCETS

FAUCET REPAIR

SHOWER & TUB

SINKS

TOILET REPAIR

VALVES

PIPE REPAIR & FITTINGS

PLUMBING SPECIALTY

TUBULAR

BATHROOM FIXTURE

PLUMBING TOOLS

DISPLAY STUFF

Kitchen-Sink Strainers

DUO BASKET STRAINER - BRASS

Cast Brass Construction. 4 1/2" Flange. Fits 3 1/2" to 4" Sink Opening.



part no.	description	min.	carton	price
52071	Chrome	5	50	39.50
52072	Satin nickel	5	50	49.38
52073	Red oil bronze	5	50	53.33
52074	Black oil bronze	5	50	53.33
52075	PVD	5	50	57.50
p52071	Retail package on cards			42.00
P52072	Retail package on cards			51.88
P52073	Retail package on cards			55.83
P52074	Retail package on cards			55.83
P52075	Retail package on cards			60.00

LOCKNUT & WASHER FOR SINK STRAINER

3 3/8" for Basket Strainer



part no.	description	min.	carton	price
52013	Die cast	8	100	2.05
52014	rough brass	8	100	3.27
52052	washer/rubber	10	1000	0.76
P52013	Retail package on cards			3.80
P52014	Retail package on cards			5.75
P52052	Retail package on cards			2.45

Bar-Sink Strainers

JUNIOR DUO BASKET STRAINER - DEEP CUP

Extra Deep Basket.
Chrome Plated Brass Construction.



part no.	description	min	carton	price
52012	2 1/2" Deep	5	50	19.30

Bar-Sink Strainers

JUNIOR DUO BASKET STRAINER

Fits 1 7/8" Sink Opening.
2 7/8" Flange - 1 1/2" Basket.
Stainless Steel.



part no.	description	min	carton	price
52003	Stainless steel	5	100	6.78
P52003	Retail package in clam shells			8.55

DUPLEX FLAT TOP STRAINERS

Fits 1 7/8" to 2 1/4" Sink Opening.
2 7/8" Flange.
Stainless Steel.



part no.	description	min.	carton	price
52009	Stainless steel	5	100	6.00
P52009	Retail package in clam shells			7.75

Strainers Parts

FLAT TOP STRAINER

4 1/2" Flange,
Fit 3" to 3 1/2" Opening
Stainless Steel.



part no.	description	min.	carton	price
51998		5	50	8.00
P51998	Retail package on cards			10.50

LAUNDRY TRAY PLUGS

Fits 1 7/8" to 2 1/4" Sink Opening.
2 7/8" Flange. Stainless Steel.



part no.	description	min	carton	price
52010		5	100	6.08
P52010	Retail package in clam shells			7.83

KITCHEN SINK SPRAY (HEAD & GUIDE)

White plastic kitchen spray head and guide.



part no	finish	min	ctn	price
35003	White	10	50	5.39

Kitchen Sink Accessories

FAUCET HOLE COVERS

Chrome Plated Top, Metal.

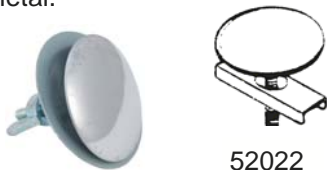

52024

52022

part no.	description	box	carton	price
52022	1 3/4"	10	500	0.75
52024	2"	10	400	1.50
P52022	Retail package in clam shell			1.56
P52024	Retail package in clam shell			2.48

KITCHEN SINK SPRAY (HEAD & GUIDE)

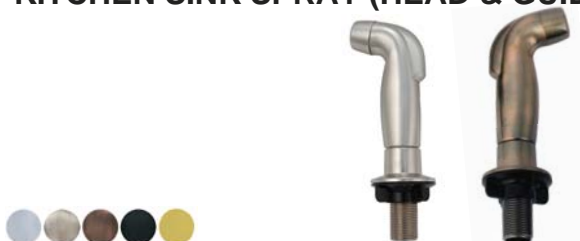

part no	finish	min	ctn	price
35008	Satin nickel	3	50	10.63
35006	Red oil bronze	3	50	11.68
35007	Black oil bronze	3	50	11.68
P35008	Retail package on card			12.38
P35006	Retail package on card			13.43
P35007	Retail package on card			13.43

KITCHEN FAUCET HOSES & SPRAYS

Vinyl with Nylon Reinforced. Brass Nut. Plastic Body.



part no.	description	box	ctn	price
35000	Complete set	1	50	9.95
35004	Guide only	1	100	1.42
35005	Head only	1	100	4.00
35005SN	Satin Nickel Head			10.55
35005ROB	Antique Copper Head			10.95
35005BOB	Oil Rubbed Bronze Head			10.95
P35000	Retail package on card			12.45
P35004	Retail package on card			2.43
P35005	Retail package on card			5.50

Kitchen Sink Accessories

DISPOSAL COVERS

White Rubber, Universal Fit.



part no.	description	box	carton	price
51015		25	200	1.76
P51015	Retail package in clam shells			3.18

DISPOSER COVER

Fit In-Sink-Erator
Disposal
XV



part no	description	box	carton	price
51083	Black	25	200	3.25
51082	Chrome	25	200	5.45
P51083	Retail package in clam shells			5.00
P51082	Retail package in clam shells			7.20

DISPOSAL CONNECTORS

Black Rubber.
Rounded with 4 Stainless
Steel Clamps.



part no.	description	box	carton	price
51013		10	200	1.60
P51013	Retail package in clam shells			2.80

DISPOSAL SPLASH GUARDS

Black Rubber, Universal Fit.

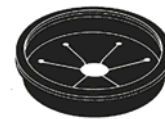

part no.	description	box	carton	price
51008		1	400	0.90
P51008	Retail package in clam shells			2.27

AIR GAPS

Brass Caps. UPC Listed.



part no.	description	box	carton	price
52020	Chrome	1	50	7.25
52062	Satin nickel	1	50	11.00
52063	Red oil bronze	1	50	12.10
52064	Black oil bronze	1	50	12.10
52065	PVD	1	50	13.18
P52020	Retail package on cards			10.25
P52062	Retail package on cards			14.00
P52063	Retail package on cards			15.10
P52064	Retail package on cards			15.10
P52065	Retail package on cards			16.18

FAUCETS

FAUCET REPAIR

SHOWER & TUB

SINKS

TOILET REPAIR

VALVES

PIPE REPAIR & FITTINGS

PLUMBING SPECIALTY

TUBULAR

BATHROOM FIXTURE

PLUMBING TOOLS

DISPLAY STUFF

Lavatory Sink Drains

POP-UP DRAIN FOR LAVATORY SINKS

Brass Construction,
Brass Pull-Knob May Vary.



part no	finish	min	carton	price
32003	Brass/chrome plated	10	50	14.13
31996	Satin nickel	3	50	23.95
31995	Red oil bronze	3	50	26.35
31994	Black oil bronze	3	50	26.35
32009	PVD	3	50	29.60
P32003	Retail package on cards			15.70
P31996	Retail package on cards			26.45
P31995	Retail package on cards			28.85
p31994	Retail package on cards			28.85
p32009	Retail package on cards			32.10

Lavatory Sink Drains

MAKE-OVER KIT FOR POP-UP ASSEMBLY

Turn old pop-up assembly into a new look, or change it into a new color. Each kit includes a plug, a flange and a pull-rod.



part no.	description	min.	carton	price
31985	Chrome	10	60	8.75
31986	Satin nickel	3	60	9.30
31987	Red oil bronze	3	60	10.18
31988	Black oil bronze	3	60	10.18
31989	PVD	3	60	11.20
P31985	Retail package on cards			10.75
P31986	Retail package on cards			11.30
P31987	Retail package on cards			12.18
P31988	Retail package on cards			12.18
P31989	Retail package on cards			13.20

POP-UP DRAIN (REPLACEMENT PARTS)

Chrome Finish.
Fit Price Pfister* Pop-Ups.



32006



32007

part no.	description	min.	carton	price
32006	Plug	10	300	1.95
32007	Flange	10	1000	1.98
P32006	Retail package on cards			2.70
P32007	Retail package on cards			2.73

POP-UP LAVATORY DRAIN

Individually packed with bar code.



part no.	description	min.	carton	price
32000	ABS/chrome plated	10	50	7.10
P32000	Retail package on cards			9.05

POP-UP DRAIN (REPLACEMENT PARTS)

Chrome Finish. Fit Price Pfister* Pop-Ups.



part no.	description	min.	carton	price
32018	Metal cap nut	10	1000	.70
P32018	Retail package in clam shell			1.33

POP-UP DRAIN (REPLACEMENT PARTS)

Chrome Finish.
Fit Price Pfister* Pop-Ups.

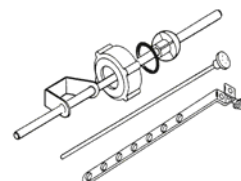

part no.	description	min.	carton	price
32005	4-Piece arm assembly	10	200	4.95
P32005	Retail package on cards			6.70

Lavatory Sink Drains

P.O. PLUG LAVATORY DRAIN

Brass Body. Perforated Grid Drain. 1 1/4" x 8 1/2". No Overflow Holes.



part no.	description	min.	carton	price
32008	Chrome	5	5	16.38
31962	Satin nickel	5	5	28.63
31963	Red O.B. (antic copper)	5	5	31.49
31964	Black oil bronze	5	5	31.50
31965	PVD brass finish	5	5	33.50
P32008	Retail package on card			18.88
P31962	Retail package on card			31.13
P31963	Retail package on card			34.00
P31964	Retail package on card			34.00
P31965	Retail package on card			36.00

LIFT & TURN LAVATORY DRAIN

Brass Construction. No Overflow holes. 1 1/4"-OD Opening.



part no.	description	min	carton	price
31971	Chrome	5	50	23.55
31972	Satin nickel	5	50	32.88
31973	Red O.B. (antic copper)	5	50	35.50
31974	Black oil bronze	5	50	35.50
31975	PVD brass finish	5	50	38.35
P31971	Retail package in clam shells			26.05
P31972	Retail package in clam shells			35.38
P31973	Retail package in clam shells			38.00
P31974	Retail package in clam shells			38.00
P31975	Retail package in clam shells			40.85

WASHER

32016



part no.	description	min.	carton	price
32016	1 1/2" For pop-up	20	100	.85
32017	1 1/4" For p.o.plug	20	100	.83
P32016	Retail package in clam shell			1.54
P32017	Retail package in clam shell			1.51

Lavatory Sink Drains

P.O. PLUG LAVATORY DRAIN

Stainless Steel Body. Chrome Finish. 1 1/4" Tube. **1-Piece Unit.** Plug with Chain Included.



part no.	description	min.	carton	price
31997	5"-Length	5	150	6.88
31999	8"-Length	5	100	8.23
31998	12"-Length	5	75	11.25
P31997	Retail Package on card			9.29
P31999	Retail package on card			10.16
P31998	Retail package on card			13.73

P.O. PLUG LAVATORY DRAIN

Brass Construction. Chrome Finish. 1 1/4" Tube. **2-Piece-Body**



part no.	description	min.	carton	price
32001	8 1/2"-Length	5	60	13.50
32004	12"-Length	5	48	16.68
P32001	Retail package on card			16.00
P32004	Retail package on card			19.68

P.O. PLUG LAVATORY DRAIN

ABS Body, Stainless Steel Flange, 1-Piece Unit, 1 1/4" x 5", Rubber Stopper with Chain.



part no.	description	min.	carton	price
32002	ABS	100	100	2.65
P32002	Retail package on card			4.81

FAUCETS

FAUCET REPAIR

SHOWER & TUB

SINKS

TOILET REPAIR

VALVES

PIPE REPAIR & FITTINGS

PLUMBING SPECIALTY

TUBULAR

BATHROOM FIXTURE

PLUMBING TOOLS

DISPLAY STUFF